

THE LUTHERAN CHURCH OF
ST. ANDREW

FOUNDATIONAL
POINTS OF
INTEREST:

- **Why Are We Doing This?**
Pages 2-4
- **What's in the Plan?**
Pages 5-7
- **Your Invitation to Foundation Building**
Pages 8-9
- **A Word from Pastor Hricko**
Page 11



Firm Foundations

FALL 2011

Greetings Fellow Builders!

We have important news to share! The bus to Firm Foundations – the completion of St. Andrew's Lower Level, plus expanded parking – is ready to roll!

As church members, parents, and leaders of this campaign, we're excited and we hope you will be too. Years ago, we were both attracted to this church family because we saw St. Andrew as a community of faith that didn't just talk the talk. This community walked the walk and followed Jesus' command to go forth and make disciples – and that holds true today.

At first glance, there was something here for everyone and every age, and there still is. There was the choir – plenty of social life 25 years ago for a young woman like Kimberly, recently moved to the area and seeking new friends and a Lutheran home. Over the years there have been activities galore, calls of concern, laughter and tears, and practical things – delivery of meals when babies were born, encouragement and assistance in all of life's ups and downs. There have been baptisms, first Holy Communion and confirmations, weddings, funerals, plus ground breaking, cornerstone laying and gallons and gallons of coffee! There has been love and acceptance



beyond belief and music and joy to lift our hearts. There have been children's programs – extremely attractive for parents with young kids. There have been arts and crafts and at one time a Thrift Shop, a place to belong and serve for Gary's 105-year-old grandmother-in-law, Kathryn Fox. There was the big move of the 8:30 service to 8:00 and the addition of contemporary worship at 11:00. And through it all, this church family rose to the occasion and then some!

Yes, there seemed to be a little bit of everything. And even with all we had, we didn't stand still. Like the parable of the talents, we took God's gifts and, by His grace, multiplied them! Our congregation has been blessed

with nearly 350 new members since 2008, while sadly many others are shrinking. Since we moved to this beautiful new site three years ago, we've invited the community in for job fairs, craft fairs, a spring fling and fall festival, model train shows and more – and we've sewed countless quilts and cooked mountains of barbecue for the needy. We've collected school supplies and Christmas toys, provided shelter meals and fasted for starving children, and served enough doughnut holes to circle the globe! And there's so much more we can do! We're a long way from 1949 when St. Andrew officially began with a

few dozen members, but our mission is the same: to spread God's word, joy, and blessings to the world around us.

Look what we did yesterday. Imagine what we'll do tomorrow with our foundation firm and complete. Join us as we embark. With

God leading the way this should be one heck of a trip, one you will be proud to be a part of!

Kimberly Gay-Armour
and **Gary Fields,**
Firm Foundations Co-Chairs



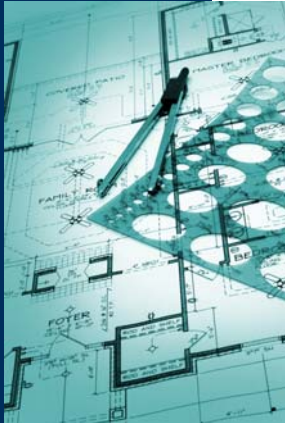

“I can’t put into words the spiritual peace and joy I feel since becoming a member of St. Andrew last year. I’m walking on air—the Spirit is back!”

Why Are We Doing This?

When the foundation is completed, it will be home to a wide-range of programs – all bringing unique brands of mission and faith to our community and changing lives in the family of God!

Confirmation Changes People

“It will be a unique space for a unique ministry,” says George Mannina, director of St. Andrew’s Confirmation Program. Formally created 15 years ago by George and Stan Jackson, the St. Andrew Confirmation Program equals dozens of “tweeners” and young teens coming together every Friday evening and Sunday morning for two years, with a team of 15 teachers guiding them through a program that combines learning with faith formation, fun and friendship in an unbeatable training ground for the next generation of Christian leaders.

Confirmands talk about things that stump adults. Are doubts okay? Are prayers always answered? What is God’s relationship with me? Why do bad things happen to good people? What does all this stuff mean to my “real life” outside church? The list goes on, and the resulting discussions bring lessons that will last a lifetime.

The impact becomes visible as the months go by. Students come in complaining about “losing” Friday nights for two years, but leave wondering what they’ll do without the friends and Friday night activities they have come to love. The proof of God’s work is in the results. Participants come back to share stories of how things we talked about made a difference in high

school, in college and beyond. They remember the times we laughed together, and the times we cried together. Some come back to teach, assuring that this program will continue long after the first generation of teachers have found their reward. Some return after college; others start serving while they are still in college! And many take their talents to teach in other places, spreading the lessons they learned far and wide.

Fun, intense, friendly, intensive – it is all about a faith journey. And that journey begins in a place. The Firm Foundations program will provide a space for Confirmands to call their own, a place where they feel comfortable, a special place we’ve never had for them before. But we will build it with your help, and it will make a difference – a place to be home!



Youth ... Our Future

One of the key tenets of Christianity can be found in Matthew 28 where Jesus tells His apostles to “go forth and make disciples.” The key words are “go forth.” That’s exactly what the SALTEENS (St. Andrew Lutheran Teens) have been doing for years. Scores of young adults have come through the program, currently run by Riki Schoppert, who became St. Andrew’s first dedicated High School Youth Minister eight years ago. As the final “launch pad” before these young adults head out into the world, our

Youth Ministry has guided them to practice what Jesus commanded so long ago. For example, St. Andrew youth have traveled to Louisiana to do clean up in the aftermath of Hurricane Katrina. They have helped

build and repair homes for the needy. They have fasted (no food!) for 30 hours to raise funds for the hungry and have collected for food pantries around the state. They have participated in marches to raise awareness and collected funds for the homeless and they have come in droves to volunteer at Vacation Bible School and other church programs. Even now they are preparing for their “Rent-A-Teen” fall fundraiser and will once again leave in their wake many “victims” of their “drive-by prayers”!

Having a new home for Youth Ministry through Firm Foundations means more opportunity for outreach and more space to bring friends. And nooks for meaningful small group discussion and sharing with others of their own age. Key for this demographic, a new home



will give teens a safe and God-honoring space to “hang out.” The new Youth Area – nicknamed the “SALT Mines” – will be equipped with ping pong and pool tables (already donated!), computers, sofas and everything “comfy and cool.” Says Riki, “This expansion will create an all-important welcoming atmosphere where teens can just be, and bring friends to catch the love of Jesus in the process!”



Kids Are Central!

KidCentral is a special place where St. Andrew’s youngest members and friends learn, laugh and grow together! Parents often seek out or return to a faith community as their children enter school, and that makes KidCentral a key point of entry for new families into our church. KidCentral currently begins in the Great Room with Praise Craze – a high-energy musical opening – then moves to classrooms in the Education Wing, where Sunday morning ministry space is at a premium! In fact, our Spiritus Choir for Children & Youth is currently relegated to a corner of the Great Room and program additions are at a

virtual stand-still until the Lower Level build-out brings more space! Debbie Stowe, KidCentral Superintendent, praises her teaching team for their long-lasting impression on young students. If you ask St. Andrew high-schoolers where Jesus lives, they’ll often say “in my heart,” a message they’ve kept with them since KidCentral days! Firm Foundations will provide much-needed space for KidCentral, Vacation Bible School, Preschool and more – all places for God’s youngest



followers to grow in His love and service – precious gifts that will carry His mission forward for generations to come!

Art & Crafts ... and Fellowship!



Marie Jackson started the Craft Ministry 21 years ago at the prompting of former Pastor George Lobien. "It was his idea that craft ministry should be a place for fellowship and growth," she said. The growth came in an unexpected way: "We found that if we were going to make crafts, we needed to sell them," she chuckles, "and so we did." Did they ever! Crafts is a resource-generating ministry that earns \$15-17,000 annually! The funds have always gone back into projects that further the mission of God.

Arts and crafts are activities without age limitations. The Wednesday morning crafters

include participants from young to old, some in their 80s and 90s, seasoned and experienced and committed to the program. Saturday mornings find another group of "weekend warriors" crafting away. A new care ministry, Creative Spirits, is currently forming to bring together hand-crafted treasures and prayer that will bless and encourage those in need. And arts and crafts happen each week in KidCentral, Preschool, and often in Confirmation and High School Youth, too. All of these groups will benefit from new and dedicated space for creative arts.

You have seen the result of their labors of love – from banners given at baptisms, to

quilts for missions, to crafts for the annual Hearts & Holly Bazaar – and that's just from our Craft Ministers. Having a dedicated space through Firm Foundations means having a home for them and others. It means not spending hours weekly setting up and breaking down machines, tables and materials in shared or borrowed space. A dedicated space can only mean growth, for those participating now and the products they are turning out, and for other ministries who will utilize the new space to expand St. Andrew arts and crafts beyond its current scope. The opportunities are endless, and the beauty of what's to come is sure to bring joy to God's heart!

"As we grow by God's grace, we will honor our rich legacy by evolving our ministry to meet current and future needs."

Wellspring: It's About Healthy Leaders

The mission of this developing ministry is to be a place "where people of God gather for spiritual renewal, personal wellness, and learning experiences that equip and inspire servant leadership." Already, several hundred participants from across the region have been blessed by programs ranging from contemplative



to informational and mostly in-between. The word is getting out, and more space is needed to expand options for fitness, group gatherings, webcasting and more.

Dorothy Cockrell, the first female elder in the history of The Lutheran Church of St. Andrew, has been a member for 59 years. She has seen the church's past and she is looking toward its future. "We've been blessed. I'm just thrilled to be part of it!" she says. Dorothy is excited that Wellspring will be expanding in our facility. "I attended a couple of wonderful Wellspring programs recently after many years of attending similar events elsewhere," she says, and she is

thrilled that with Firm Foundations, we will finally have space to bring together information, inspiration and holistic wellness in a unique way that is sure to bless those inside and outside our community. "Pastor Richard Hinz, former SED President, was the original inspiration for Wellspring. He was a member of our congregation and his vision was to provide these kinds of much-needed renewal programs for church workers and others. Through Firm Foundations, I know we are honoring this legacy and fulfilling his vision."

What's in the Plan?

At the time ground was broken on New Hampshire Avenue back in 2007, our St. Andrew leaders stepped out in faith to invest funds for excavation of the Lower Level, not knowing when we would ever need the extra space. By God's grace, only three years after our move to this new site, we are "bursting" at the ministry seams and the 25,000 square feet below us is a treasure waiting to be tapped!

Three distinct entry points (Youth, Education & Plant) will allow for security and flexible access depending on needs. And, speaking of entry, turn the page to enter and view the exciting plans for the Lower Level build-out that Firm Foundations funds will make a reality!

More Parking, Anyone?



A bonus to Firm Foundation plans is the ability to add much-needed **parking for 46 vehicles** on the north side of our property. Anyone who has been here on a holiday or even a busy Sunday will appreciate the importance of this step. The new lot will feature lighting and an option to secure the space from the main driveway and lot to ensure safety during children's recreation and activities. (Note: Playground will be relocated adjacent to the preschool to accommodate new parking area.)

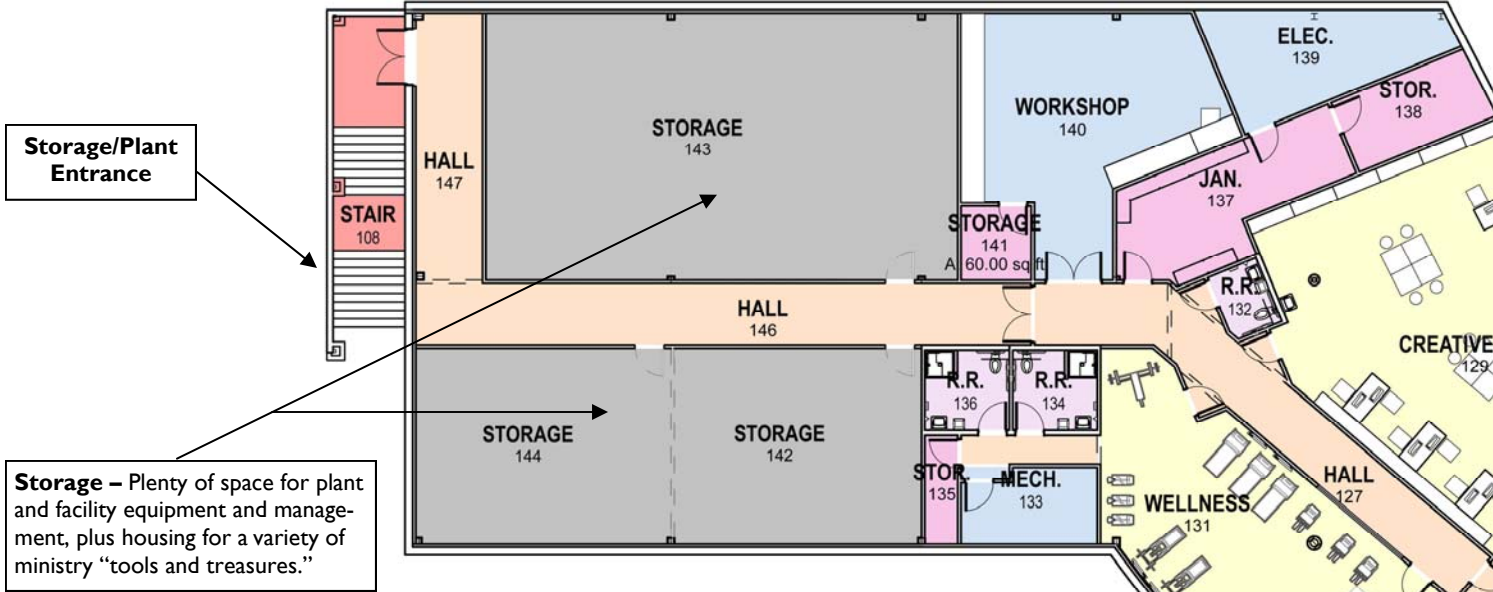

Storage – Plenty of space for plant and facility equipment and management, plus housing for a variety of ministry “tools and treasures.”

Wellness – Space for fitness activities and equipment, plus an adjacent office and/or gathering space for counseling, small group meetings, etc. TV panels will bring instruction, entertainment and motivation to the experience. Changing rooms and showers are directly adjacent. For use by Wellspring and others.

Central Foyer – This main “hub” at the foot of the Commons stairwell will provide welcoming entry to the Lower Level and easy access into each ministry space.

Lower Level Floor Plan

Wellspring – Flexible meeting and worship space will accommodate up to 100 in classroom-style seating or 64 at round tables. Area served by a warming kitchen, dedicated A/V system, and direct access to table/chair storage. Available for use by St. Andrew ministries and others.

Video Conferencing – Advanced audio/video capabilities for presentations, webcasting, and more.

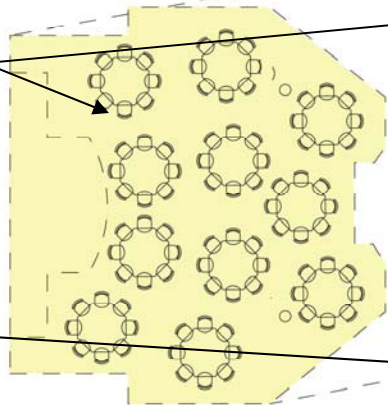



Firm Foundations

Creative Arts – Spacious environment to accommodate craft tools and machines, tables for collaborative work, and lots of storage!

Youth Entrance

Youth – Fun and functional “hang out” and meeting space for group activities, including flexible area for smaller breakouts, large “gathering-friendly” foyer, a snack bar and youth office.

Classrooms – Will comfortably seat up to 100 participants in a variety of learning settings. Initially targeted for our expanding Confirmation program, these rooms will accommodate participants of all ages in gatherings of all types including KidCentral and VBS.

Education Entrance



This Is Your Invitation ...



When we love deeply, no sacrifice feels burdensome. Imagine the impulsive joy of giving when love first blossoms, or the response of a grandparent cuddling the next generation! Can you recall a time when you received an act of kindness so timely or the generosity of forgiveness so longed for – that you yearned to give back meaningfully and earnestly? Now and then we sample a taste of God’s delicious design, filled with receiving, responding and giving – and it changes us.

God’s Word reminds us that all we have comes from God’s own grace and the bounty of creation. God loves us so much that He breathes us into being and sustains us with every resource. Even more amazing, God calls us into

continued partnership – a co-creative process – that adds immeasurable purpose to our lives. In truth, all we have is from God, entrusted to us so that we might know God, enjoy a relationship with Him, and minister to this world God loves so much that He sent His only Son, our Savior, Jesus Christ. Such understanding is the core of our motivation to give to God through our church.

Right now, The Lutheran Church of St. Andrew is poised to take another bold step in mission and ministry. Lives will be transformed and ministry will be accomplished – all for the Glory and purposes of God. Imagine what God can yet do with our church as we respond in faith with enthusiasm and joy!

“Now and then we sample a taste of God’s delicious design, filled with receiving, responding and giving – and it changes us.”

Our Challenge

To gather gifts and pledges of \$1.8 million during the next three years to build these firm foundations for the cause of Jesus Christ so that people of all ages will come into contact with the reality of a God who loves us and has the power to change our lives!

Costs of the Vision:

Completion of the Lower Level	\$ 1,700,000
Additional Parking	+ 200,000
Operations and Programming	+ 400,000
TOTAL COSTS	\$ 2,300,000

Funding Plan for the Vision:

Seed money from “Continue the Journey”	\$ 500,000
Firm Foundations Goal	+ 1,800,000
TOTAL FUNDING	\$ 2,300,000

Our Pastors and leaders invite you to prayerfully consider giving back to God's mission as generously as you are able over the next three years, to build upon the Firm Foundation we share in Christ.

Please use the Commitment Card enclosed in this folder to respond. A chart to assist in your planning is also included. You may make your gift in cash, by check, electronically on a one-time or recurring basis, or by security transfer.

For more information on any of these giving options, contact Dick Goetsch, St. Andrew Treasurer, through the church office at 301-384-4394 or www.mystandrew.org.



May you experience the satisfaction, joy and blessing of responding to God in faith and action through cheerful, generous giving! Your participation will make a very real difference in lives.

... to be a Foundation Builder!

Gifts of all sizes, joyfully given, are needed to accomplish this goal:

1	Gift of	\$250,000
1	Gift of	\$100,000
2	Gifts of	\$50,000
5	Gifts of	\$40,000
10	Gifts of	\$25,000
15	Gifts of	\$15,000
20	Gifts of	\$10,000
50	Gifts of	\$5,000
Many	Gifts of	\$1,000

... or as God leads you to respond to His grace and gifts in your life.





For we are co-workers in God's service; you are God's field, God's building.

By the grace God has given me, I laid a foundation as a wise builder, and someone else is building on it.

But each one should build with care. For no one can lay any foundation other than the one already laid, which is Jesus Christ.

I Corinthians 3:9-11



A Word From Our Pastor

Dear Fellow Members and Friends of St. Andrew,

Throughout the building of our new church home a little more than three years ago, I paid frequent visits to the construction site. To this day I clearly remember walking on the foundation before anything was above it, then stepping among steel columns, and eventually standing in spaces that would become the “many rooms” of our worship and service together, including the spot where our altar now rests. During those visits, I would often wonder. Who will come to this place because of the work of Christ in the people of St. Andrew who were taking such a step of faith? Who will yet experience a new beginning in their relationship with God at this house and with these people? Who will be baptized here, confirmed here, and comforted here? Who will be brought to faith itself as God takes our prayerful and sacrificial gifts and uses this new facility for the mission of Christ?

With thanksgiving to the God of new beginnings, I can now point

to hundreds of answers to those questions and the prayers that were born in my heart through them. In three short years, our Lord has significantly added to our number, enlivened our ministry, and strengthened our witness to the world. We’ve watched as several ministries grew and others were born. We expanded our parking lot once and find the need to expand it again. And if I ever wondered whether our community of faith would truly need to complete the expansive lower level of this new home, the answer to that question has also been provided, and it is a resounding “yes!” After all, the mission before us has not been completed and there is far more yet to be done.

Now I wonder again. Who will God bless in the future through the ministries that will be made possible through our commitment to Firm Foundations? Will it be a young person invited into one of our ministries to children and youth? Will it be a friend of yours who finds community in Christ through our Creative Arts ministry? Or will it be someone

else we have yet to meet who will come here and discover that no matter who they are, they can have a place in the family of God?

By God’s grace, those questions are the motivating force of our family’s commitment to support the Firm Foundations campaign so that once again, we can stand together on the foundation of Jesus and step forward together for the sake of His glorious mission to the world. They also leave me unashamed to ask you to search your heart and participate prayerfully, sacrificially and joyfully in an act of courageous giving in these challenging times. There is no greater difference that you can make than when you make a difference in some someone’s heart and soul forever. The stakes are just that high! By God’s grace, the time is now! And whatever our sacrifices may represent, they will be more than worth it. Just look around and see what God is doing!

Once again, I thank God for answering my questions and for allowing me to be a pastoral witness to the work of Christ among you. Above all, I thank Him for Jesus Christ, who is the Foundation of my life, yours and the dynamic ministry we are honored to share at St. Andrew. And from my heart, I thank you for your prayerful, sacrificial and joyful participation in Firm Foundations.

Love, in Christ,



Mark A. Hricko
Pastor



“As we embark together once again, I wonder: Who will God bless in the future by the ministries that will be made possible through our commitment to Firm Foundations?”





The Leaders of Firm Foundations Invite You To:

- Give thanks for the growing ministry of St. Andrew.
- Pray about our next step forward.
- Get involved in our journey for Christ.
- Make a joyous and sacrificial pledge toward the building of God's kingdom.

"We have learned that buildings don't change lives, but what goes on in them does! Our new church home has been a place where God's family has grown. Now we have the chance to move ahead to our next goal so that more children, young people and adults of every race and generation will meet Jesus as the foundation of their life!"



15300 New Hampshire Avenue
Silver Spring, MD 20905
Phone: 301-384-4394

E-mail: my.standrew@verizon.net

Website: www.mystandrew.org

